

# BALL VALVES INTEC

**K414, DN15 - DN100, PN16/40**  
**trunnion mounted, PEEK seated,**  
**spring loaded seat rings**

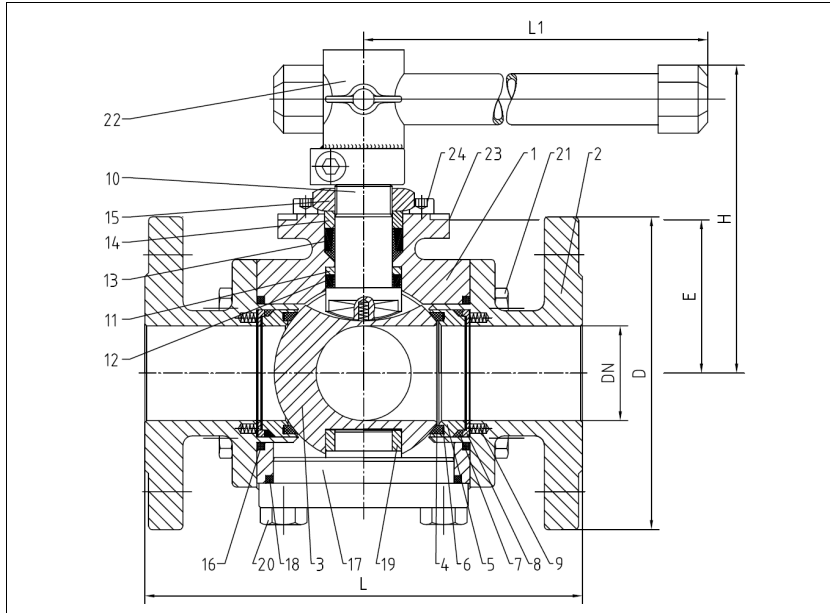

**3-way ball valve with flanges**  
**full bore**  
**face to face acc. to EN 558, GR.1**  
**flanges acc. to EN 1092**

**Specification:**

3-way ball valve with flanges acc. to EN 1092, face to face dimensions acc. to EN 558, GR.1, full bore, ball with L- or T-bore, blow-out-proof stem, body material stainless steel (1.4408/1.4571/1.4404) or carbon steel (1.0619/1.0460), antistatic device, trunnion mounted ball, seats full chambered, stem packing Graphite/KFGN/KFAM cone ring system dynamic loaded adjustable, top flange DIN EN ISO 5211, approved by PED, certified acc. to GERMAN clean air act VDI 2440, with lever.

Also possible as high temperature version up to +260°C.

Marking: INTEC K414

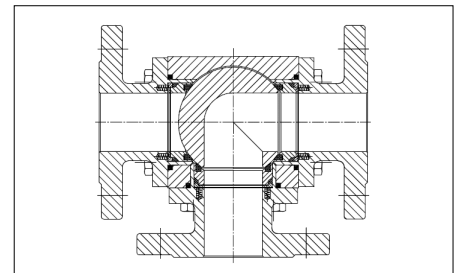

No.	Part	Material	Material
<b>Standard design</b>			
1	body	1.0619/1.0460	1.4408/1.4571/1.4404
2	cap	1.0619/1.0460	1.4408/1.4571/1.4404
3	ball	1.4408/1.4571/1.4404	
4	seat	PEEK	
5	seat bearing ring	1.4571/1.4404	
6	seat back seal	Graphite	
7	seat seal	KF	
8	follower ring	1.4571/1.4404	
9	spiral spring	1.4401	
10	stem	1.4462	
11	below stem bearing	PEEK	
12	below seal	KFGN/Graphite	
13	upper seal	KFAM/Graphite	
14	upper stem bearing	PEEK	
15	hex. nut self-locking	A2/1.4301	
16	body seal	KF	
17	bearing neck	1.4571/1.4404	
18	trunnion seal	KF	
19	bearing	PEEK	
20+21	hex. screw	A4-70	
22	lever	1.4408/1.4308/steel zincplated	
23	stopper	1.4301	
24	allen screw	A2-70	
<b>Fire-Safe design</b>			
7	seat seal	Graphite	
9	spiral spring	Inconel X750	
16	combined body seal	KF-Graphite	
18	trunnion seal	KF-Graphite	
14	Fire-Safe seal	Graphite	
	ring	1.4571/1.4404	
	thrust washer	PEEK	

**Dimensions**

DN mm	PN	dimensions (mm)				top flange ISO	weight kg	
		H	L1	L	D			
15	40	119.5	180	130**/210	95	55.0	F05	8.5
25	40	124.5	300	160	115	65.0	F07	10.0
40	40	171.0	500	200	150	76.5	F10	20.1
50	40	175.5	500	230	165	81.0	F10	24.4
80	40	204.0	700	310	200	120.0	F12	35.5
100	40	218.0	700	350	235	134.0	F12	48.2
100	16	218.0	700	350	220	134.0	F12	45.5

\*\* wafer type

Port Type	1	2	3	4
L				
T				

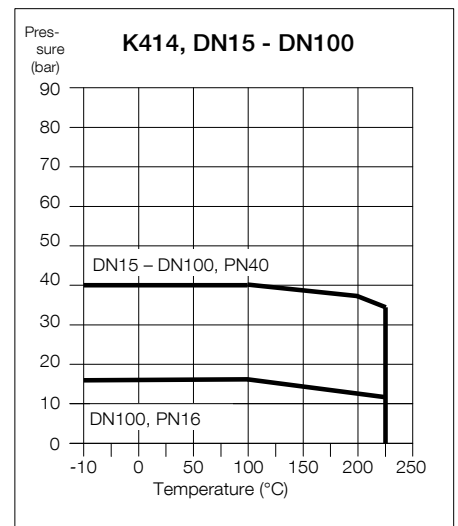

**Ordering example:**  
**INTEC K414, DN50, PN40, GR.1, 1.4408**

Subject to technical modification. 10/2019